

**POLYETHYLENE SEPTIC TANKS**

MODEL NO.	MOH No.	Working Capacity			Dimensions (inches)		
		Imp. Gals	US Gals	Liters	Dia./W	L	H
<b>RKS600</b>	<b>202</b>	<b>610</b>	<b>732</b>	<b>2,773</b>	<b>72</b>		<b>76</b>
<b>RKS750</b>	<b>219</b>	<b>760</b>	<b>900</b>	<b>3,455</b>	<b>73</b>		<b>89</b>
<b>RKS800</b>	<b>398</b>	<b>800</b>	<b>960</b>	<b>3,637</b>	<b>52</b>	<b>118</b>	<b>61</b>
<b>RKS950</b>	<b>350</b>	<b>950</b>	<b>1,140</b>	<b>4,319</b>	<b>64</b>	<b>107</b>	<b>63</b>
<b>RKS1200</b>		<b>1,200</b>	<b>1,440</b>	<b>5,455</b>	<b>66</b>	<b>150</b>	<b>74</b>
<b><u>TWO CHAMBER</u></b>							
<b>RKS800/2</b>	<b>399</b>	<b>800</b>	<b>960</b>	<b>3,637</b>	<b>52</b>	<b>118</b>	<b>61</b>
<b>RKS950/2</b>	<b>351</b>	<b>950</b>	<b>1,140</b>	<b>4,319</b>	<b>64</b>	<b>107</b>	<b>63</b>
<b>RKS1200/2</b>		<b>1,200</b>	<b>1,440</b>	<b>5,455</b>	<b>66</b>	<b>156</b>	<b>74</b>

Model No. RKS include a 16" diameter lid, 4" diameter PVC inlet and outlet fittings complete with inspection ports.

MOH # is the Province of BC Ministry of Health's Approval number.

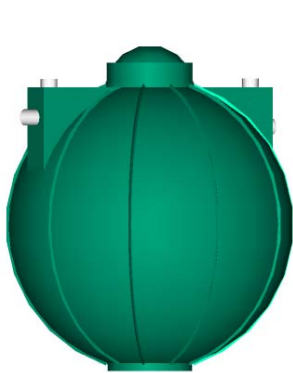

RKS600. SEPTIC TANK

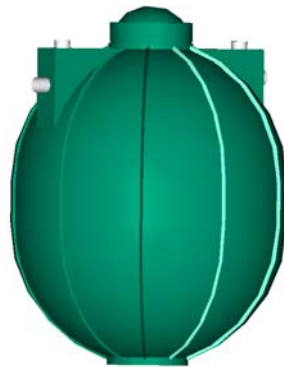

RKS750. SEPTIC TANK

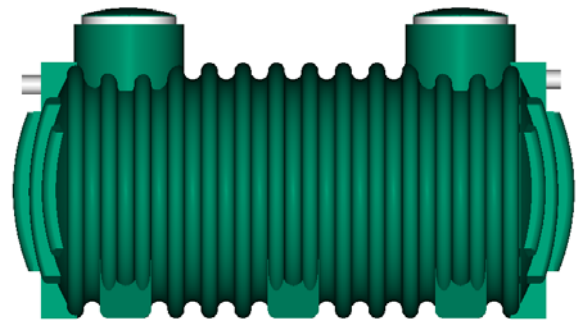

RKS800. SEPTIC TANK

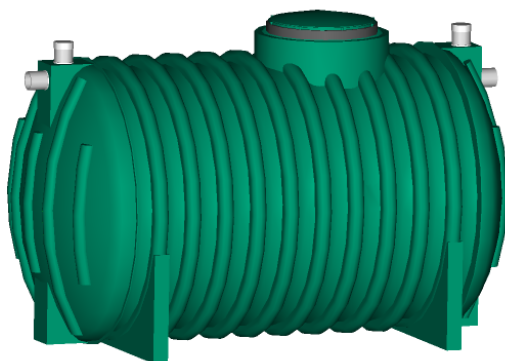

RKS950, SEPTIC TANK

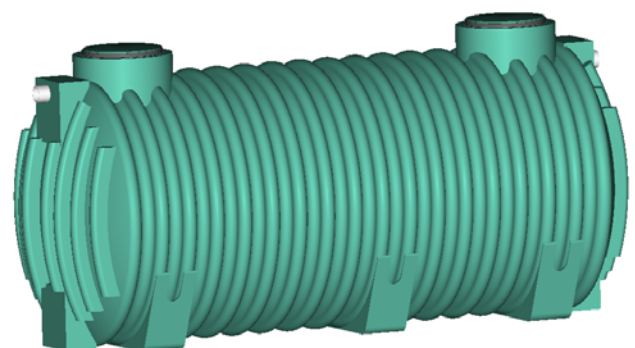

RKS1200 SEPTIC TANK