

# Canwest Tanks & Ecological Systems

– Plastic Tanks for Storage of Potable Water,  
Rainwater, Chemicals & Other Liquids –  
– Septic Tanks & Sewage Treatment Plants –



## Fiberglass Septic Tanks Septic Holding

MODEL No.	Type	No. of Bedrooms	Capacity		Dimensions (Imperial)	Weight (lbs.)
			Litres	Imp. gal		
<b>SHT2000-2</b>	2' Bury	2	11,933	2,625	6'dia. x 15'8" long	1,000
<b>SHT2000-AB</b>	Above Ground					1,300
<b>SHT3000-2</b>	2' Bury	3	14,320	3,150	6'dia. x 17'3" long	1,150
<b>SHT3000-AB</b>	Above Ground					1,850
<b>SHT4000-2</b>	2' Bury	4	18,000	3,960	6'dia. x 22'6" long	1,250
<b>SHT4000-AB</b>	Above Ground					2,150
<b>SHT5000-2</b>	2' Bury	5	22,750	5,000	6'dia. x 27'9" long	1,900
<b>SHT5000-AB</b>	Above Ground					3,100
<b>SHT6000-2</b>	2' Bury	6	26,253	5,775	6'dia. x 34'6" long	2,475
<b>SHT6000-AB</b>	Above Ground					3,900

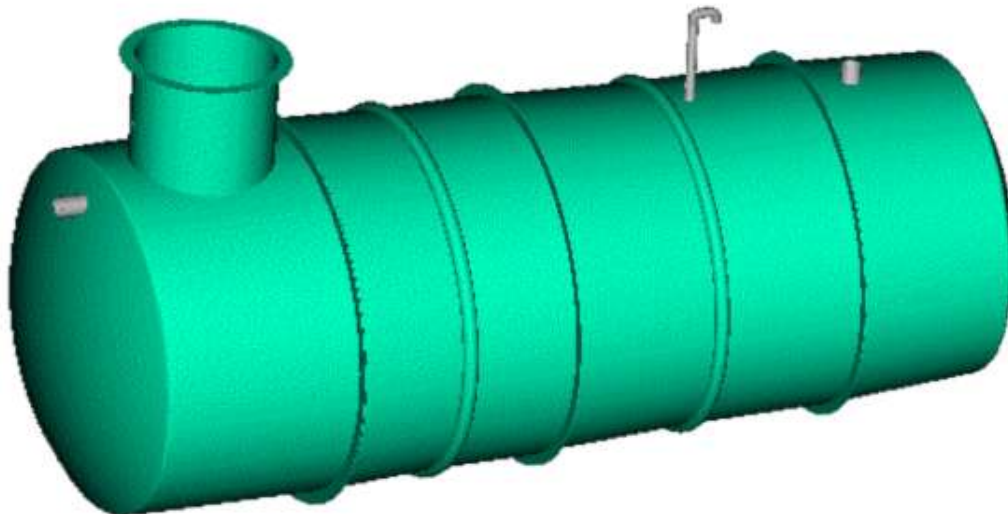

Canwest Tanks & Ecological Systems Ltd. • 11975 Old Yale Road, Surrey, BC Canada V3V 3X4

Ph: 604-580-3030 • Fax: 604-580-1171 • Toll Free 1-888-704-3030 • Email: canwest@direct.ca • Website: www.canwest-tanks.com