

Canwest Tanks & Ecological Systems

– Plastic Tanks for Storage of Potable Water,
Rainwater, Chemicals & Other Liquids –
– Septic Tanks & Sewage Treatment Plants –



Fiberglass Septic Tanks Single Chamber & Siphon Chamber

MODEL NO.	Septic Working Capacity Imp. gal	Septic Working Capacity Litres	Max Siphon Discharge Imp. gal	Max Siphon Discharge Litres	Weight Shallow Bury (lbs.)	Weight Deep Bury (lbs.)	Dimension Imperial
1100PC	1,081	4,914	308	1,400	475	715	5' dia x 14'7"
1500PC	1,523	6,924	308	1,400	585	835	5' dia x 18'5"
1800PC	1,854	8,428	308	1,400	675	935	5' dia x 21'5"
2100PC	2,075	9,433	308	1,400	745	1,015	5' dia x 23'7"
2200PC	2,200	10,001	450	2,046	940	1,500	6' dia x 17'6"
2500PC	2,500	11,365	450	2,046	985	1,555	6' dia x 19'
3000PC	3,000	13,638	450	2,046	1,145	1,805	6' dia x 22'6"
3500PC	3,500	15,911	450	2,046	1,235	1,915	6' dia x 25'6"
4000PC	4,000	18,184	450	2,046	1,395	2,165	6' dia x 29'
4500PC	4,450	20,230	450	2,046	1,440	2,220	6' dia x 30'6"

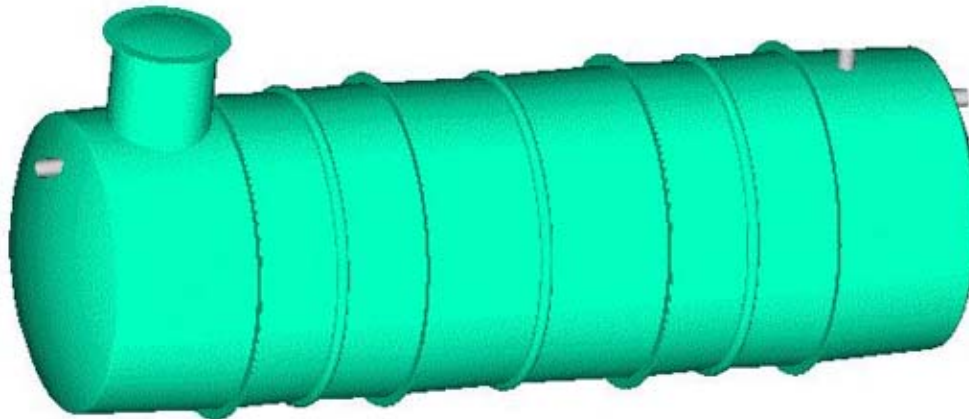

Canwest Tanks & Ecological Systems Ltd. • 11975 Old Yale Road, Surrey, BC Canada V3V 3X4

Ph: 604-580-3030 • Fax: 604-580-1171 • Toll Free 1-888-704-3030 • Email: canwest@direct.ca • Website: www.canwest-tanks.com